

PLUMBERS INSTALLATION INSTRUCTIONS

Important Information

- * Brazed connections should NOT be made directly onto the mixer, as excessive heat will cause permanent damage.
- * All pipework must be thoroughly flushed prior to installation.

Installation (Fig. 1)

- 1) Fit mixer body (11) onto a suitable mounting plate or noggin in the wall and secure using screws through the holes in its base. When facing the mixer, the connections should be as follows :
Hot water inlet connection 'H' to the left.
Cold water inlet connection 'C' to the right.
Outlet to shower 'S', vertically upwards.
Outlet to bath, vertically downwards.
Check all connections for leaks and the tap for correct operation.

Important :

- * Mixer body (11) must be installed square to wall/tile face, to ensure cover plate (7) sits flush.
- * To avoid damaging the decorative finish, do not remove the plastic protective sleeves until installation has been completed.

- 2) Apply a suitable clear sealant to the back edge of the cover plate (7), to prevent water from entering the wall cavity, leaving an unsealed section at the bottom for drainage. (See Fig. 2)
Fit rubber seals (5) & (6) into cover plate (7). Slide cover plate evenly onto diverter sleeve (12) and mixer body (11), pushing firmly against the cover plate (7) until it contacts the wall/tile face & the sealant has formed a waterproof joint. Wipe clean any excess sealant from the chrome surfaces & the wall/tile face (See Fig. 1).
- 3) Fit handle (1) taking care that it is pushed fully onto cartridge stem, tighten screw (2) using the 2.5mm allen key (4). Fit indicator plug (3) position with red to the left.

IMPORTANT

Pressure & Temperature Requirements.

- Hot and cold water inlet pressures should be equal.
- Static inlet pressure range : 150 -1000 kPa
New Regulation :-500 kPa maximum static pressure at any outlet within a building. (Ref. AS/NZS 3500.1)
- Maximum hot water temperature : 80°C.

Installation Requirements.

- The installing plumber is responsible for waterproofing all penetrations for Taps in Shower areas at installation by a proprietary flange system or a sealant.(Ref AS3740)

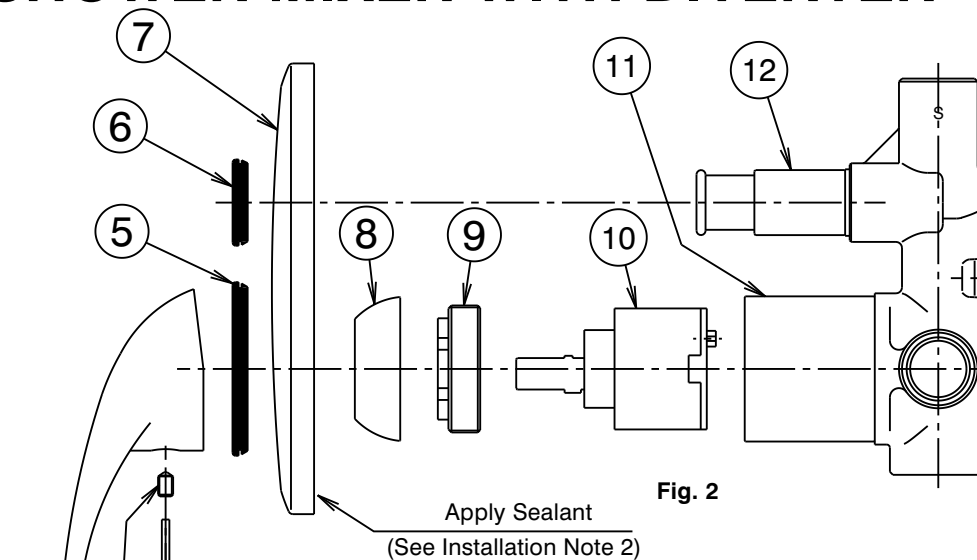

Fig. 2

Replacing Cartridge (Fig 2.)

- 1) Turn off hot and cold water supplies.
- 2) Carefully remove indicator plug (3), loosen screw (2) and remove handle (1). Unscrew cap (8) taking care not to damage the decorative finish. Remove nut (9), then lift out the old cartridge.
- 3) Ensure inside face of mixer body (11) is clean. First check that seal is in position in base of new cartridge then fit new cartridge (10) into mixer body (11), taking care that two lugs on base of cartridge (10) fit into mating holes in mixer body (11).
- 4) Screw on nut (9) **Important :** Nut (9) should be tightened to a torque of 12Nm. Replace cap (8) and tighten firmly by hand.
- 5) Fit handle (1) taking care that it is pushed fully onto cartridge stem, tighten screw (2) using the 2.5mm allen key (4). Fit indicator plug (3), position with red to the left.
- 6) Turn on water supplies and check operation.

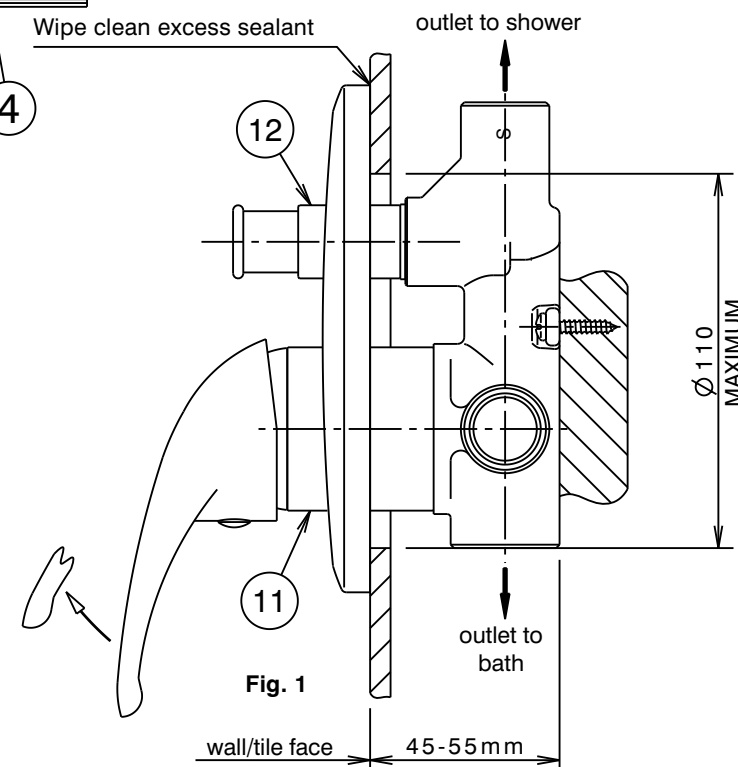

Fig. 1