



CAROMA

INSTALLATION PROCEDURE FOR ELVIRE CLEANFLUSH WALL HUNG PAN

NOTE - Installation must be on a non-compressible wall material.

- 1- Install Caroma bracket and pipework to specified dimensions, as detailed in **Fig. 3**.
- 2- Ensure the contact area on the wall for fitting the pan is flat and true. Check with straight edge before installation.
- 3- Set the length of the Fixing Studs 38mm from the finished wall surface, as detailed in **Fig. 4**.
- 4- Set the Inlet Pipe to 29mm from the finished wall, as detailed in **Fig. 4**.
- 5- Fit Keeseal onto the Inlet Pipe.
- 6- Fit Rubber Gasket into position.
- 7- Fix the Fixing Sleeves onto Fixing Studs so that 10mm of thread is exposed in front of the Rubber Gasket, as detailed in **Fig. 1**.
- 8- Make sure the notch in the Fixing Sleeves is facing downwards towards the floor.
- 9- Fit the plastic Fixing Bushes into the holes provided in the back of the pan with the Fixing Rod facing down towards the floor, as detailed in **Fig. 2**.
- 10- Smear Pan Collar and Inlet Keeseal with soap solution for push on installation of pan.
- 11- Install the pan onto the Fixing Sleeves ensuring engagement onto the Inlet Pipe and Pan Collar and hold in position.
- 12- Insert Fixing Key through the underside of the pan into the Fixing Rods which engage the Grub Screws and tighten each Grub Screw to a maximum torque 7Nm[62 lbf-in] on both sides to hold the pan onto the bracket.
- 13- Fit toilet seat.
- 14- For optimum installation, it is recommended that the joint between the pan and finished wall be caulked with acetic cured silicone sealant.

INCLUDED :

- D.991 Fixing kit (1)
- Rubber Gasket (1)
- 50mm Keeseal (1)

All measurements are subject to accepted manufacturing tolerances.
To ensure accuracy please check actual product dimensions before drilling for installation.
The manufacturer reserves the right to change specifications at any time without giving prior notification.
This product should be installed by a qualified plumber. Local authority, Water Board, and Building Regulations may apply to the installation of this product, and you should consult the appropriate bodies on these requirements.

VITREOUS CHINA ELVIRE CLEANFLUSH WALL HUNG PAN

PLUMBERS INSTALLATION INSTRUCTIONS PLEASE READ CAREFULLY BEFORE INSTALLATION

Fixing Detail

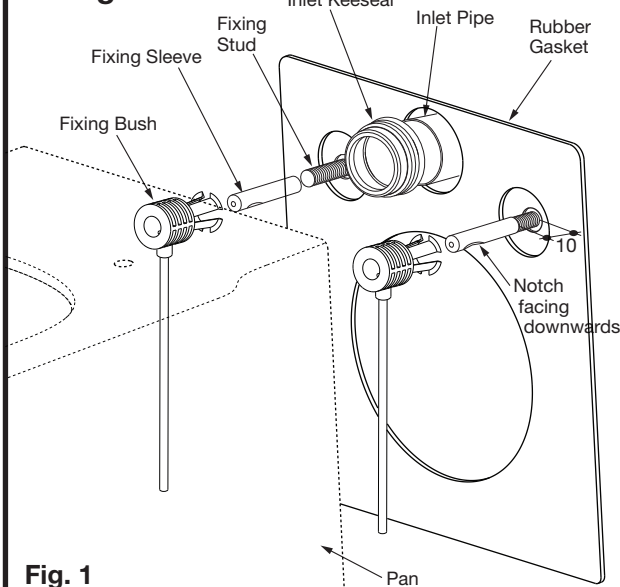

Fig. 1

Fixing Detail

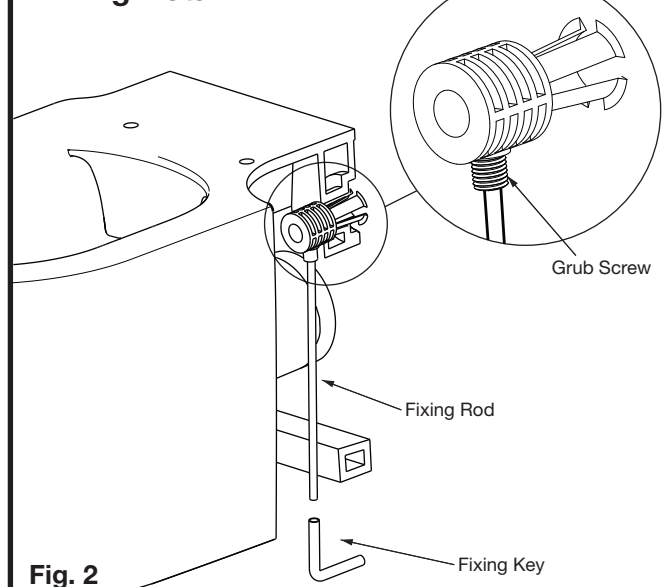

Fig. 2

Set-Out Dimension for Elvire Pan

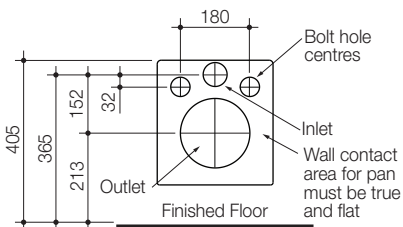

Fig. 3

Inlet Detail

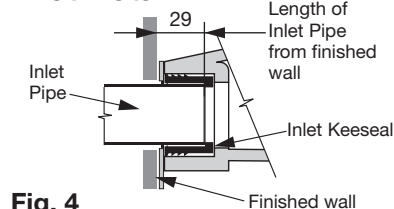

Fig. 4

Installation Detail

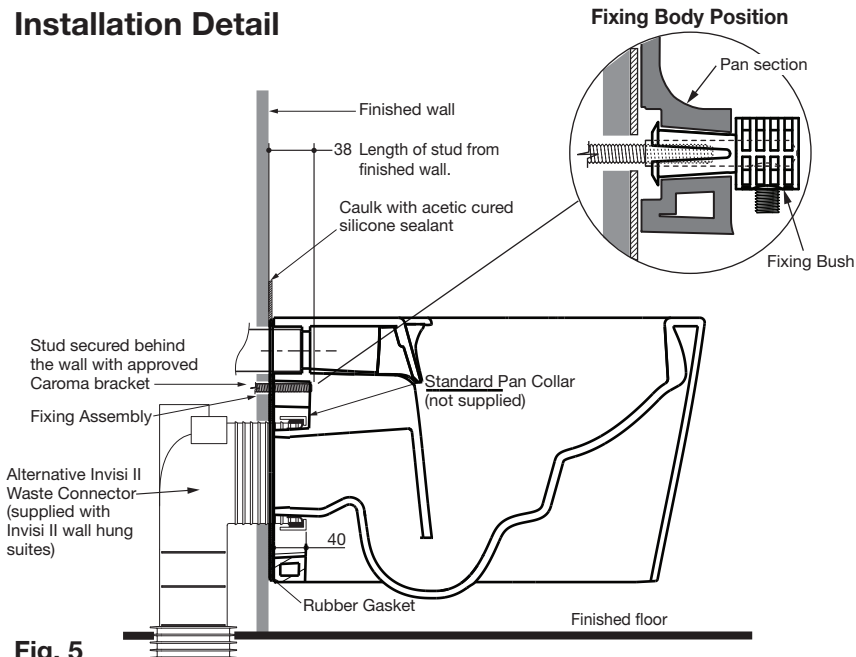

Fig. 5